

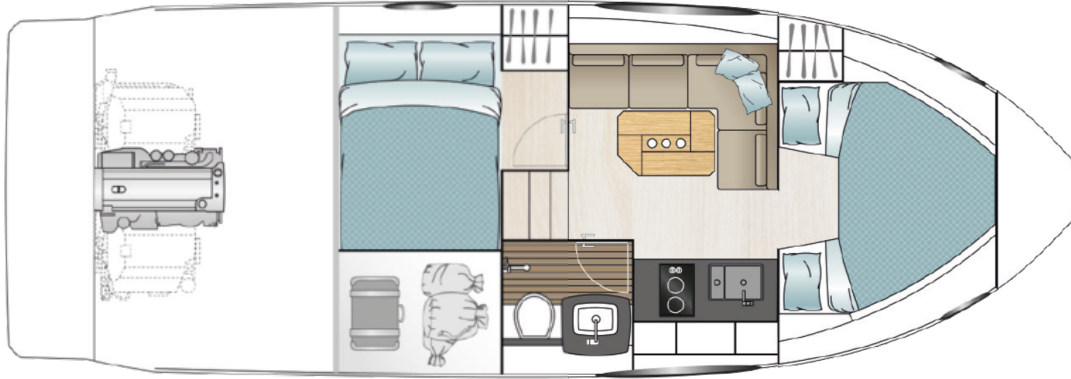

## YOUR SEALINE S330 CABIN LAYOUT



C1

C1: Guest cabin with double berth, 1 wardrobe and storage

B1

B1: Saloon with "L"-shaped sofa and storage. Galley with stowage, fridge, 2 burner gas hob and sink with draining basin, fully equipped head with handheld shower.

A1

A1: Master cabin with "V" berth, wardrobe and drawers underneath the bed. 3 Skylights, one openable. Open access to saloon.